

Medinote - Tools

Overview

The below goes over the various tools provided in the toolbar.

Pen

A pen tool to draw strokes on the canvas



Configuration

- Thickness
- Color

Eraser - normal

Eraser that erases anything under.



Configuration

- Tilt - Eraser becomes larger with larger tilt



Eraser - object

An eraser that erases the entire line that it touches

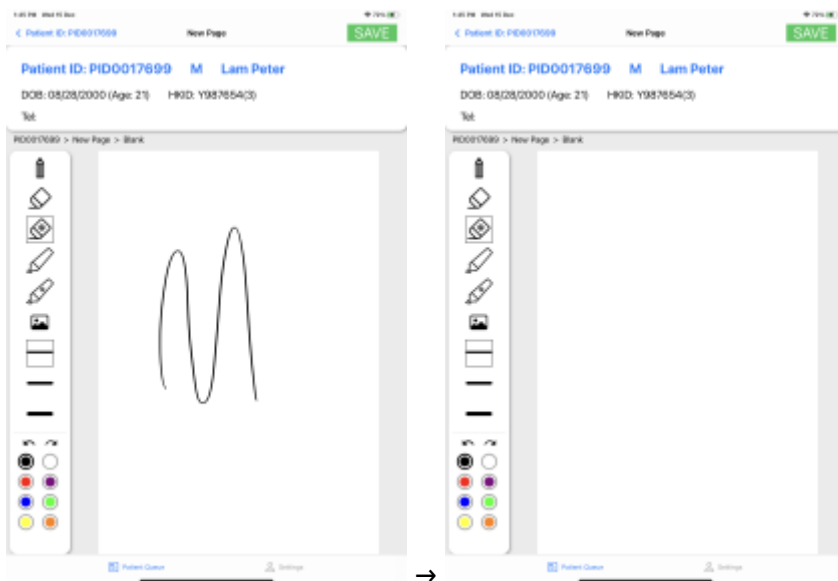

Configuration

Highlighter 1

A highlighter tool

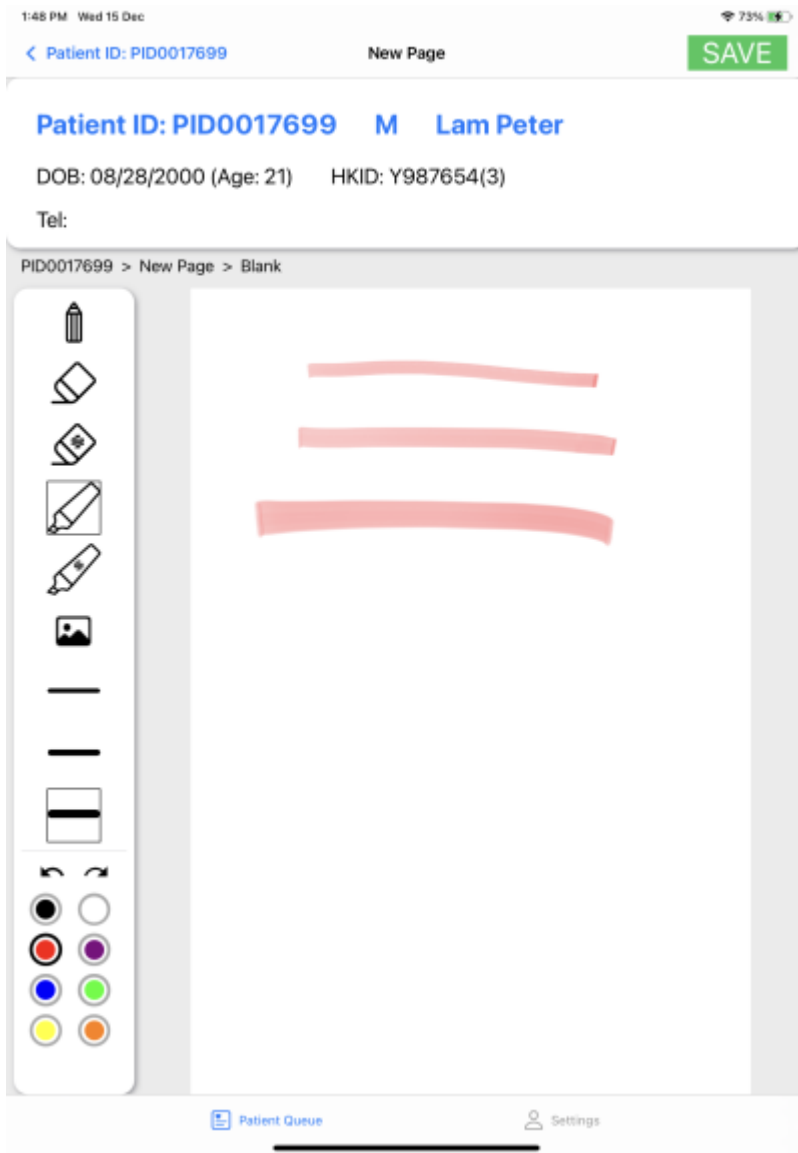

Configuration

- Thickness
- Color
- Tilt - Highlighter width becomes larger with larger tilt



Highlighter 2

A highlighter tool, looks slightly different to highlighter 1 Highlighter 2 looks similar to pen tool

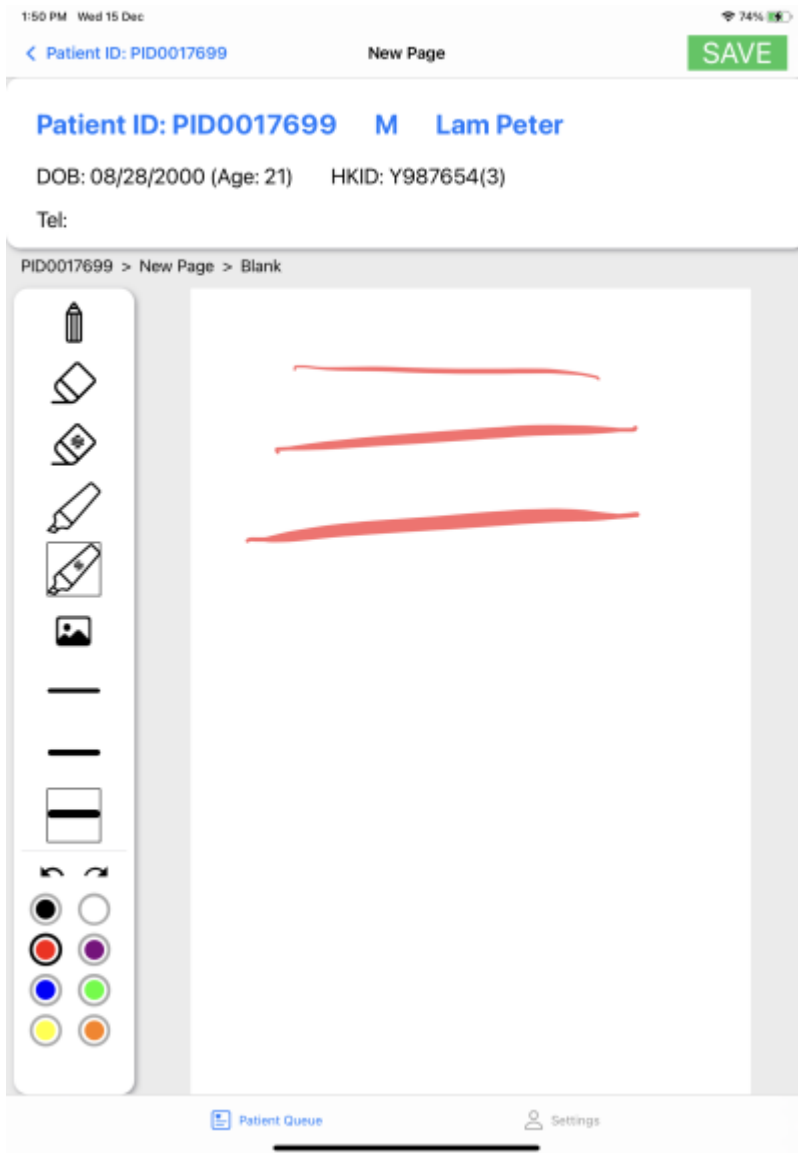

Configuration

- Thickness
- Color
- Tilt - Highlighter width becomes larger with larger tilt



Image

Click the image tool icon to open a gallery picker, tap the canvas to insert the image. You may move, resize and delete the image in the canvas



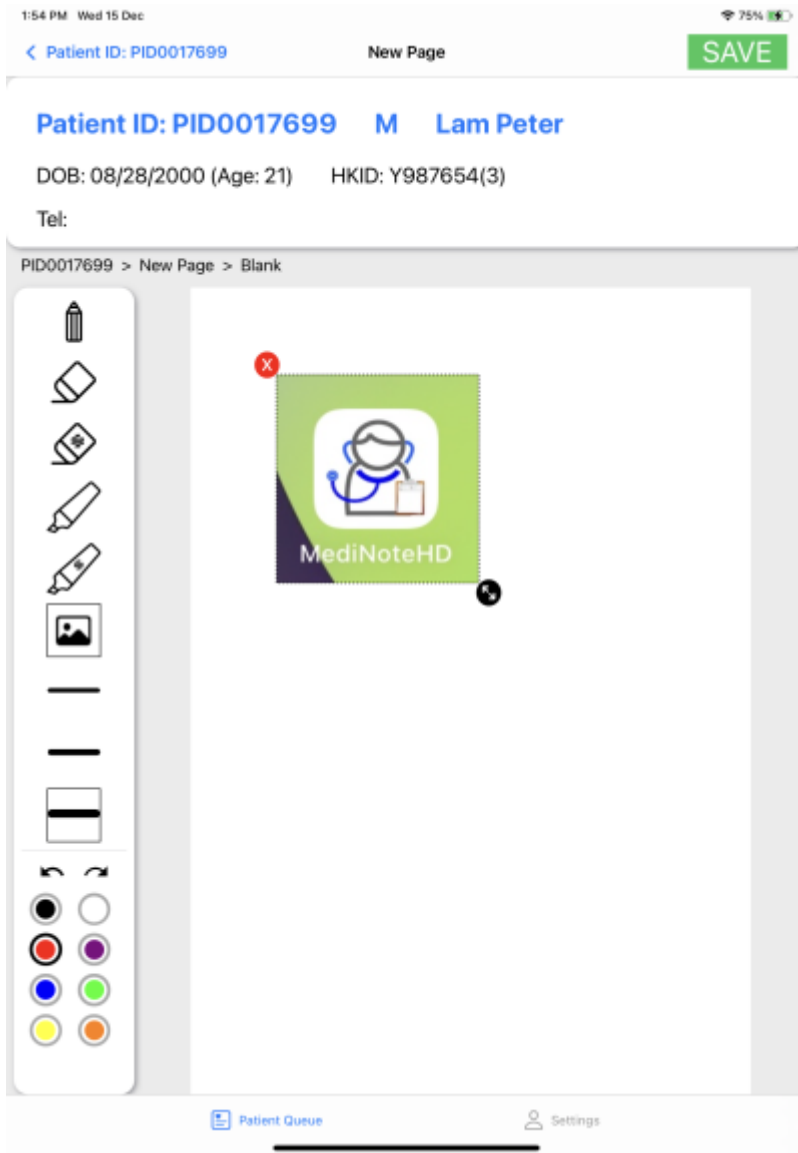

Configuration

- Image - click the image tool icon again to open a gallery picker

From: <https://wiki.questwork.com/dokuwiki/> - Questwork's Wiki

Permanent link: <https://wiki.questwork.com/dokuwiki/doku.php?id=course:medinote:tools:start&rev=1639547782>

Last update: 2021/12/15 13:56

