

Teamviewer

遠程重啟 Remote reboot

Whenever Windows requires reboot, always use the Teamviewer remote reboot function, so that it will auto re-connect after reboot

Step 1. Actions → Remote reboot → Reboot

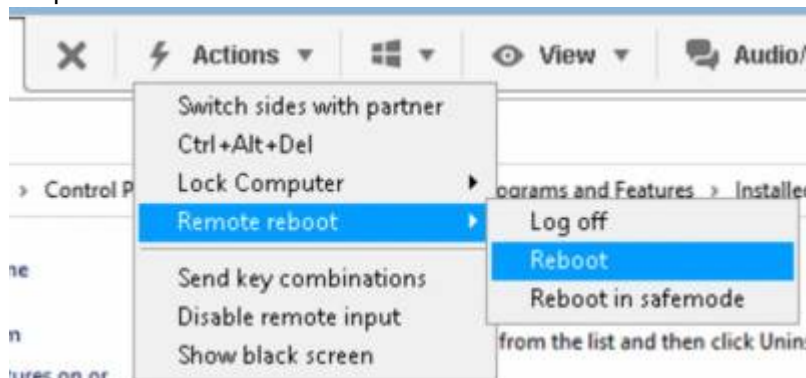

Step 2. Reboot

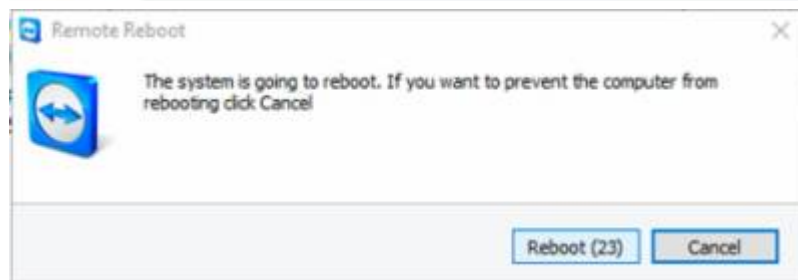

Step 3. Wait for partner



Step 4. Reconnect

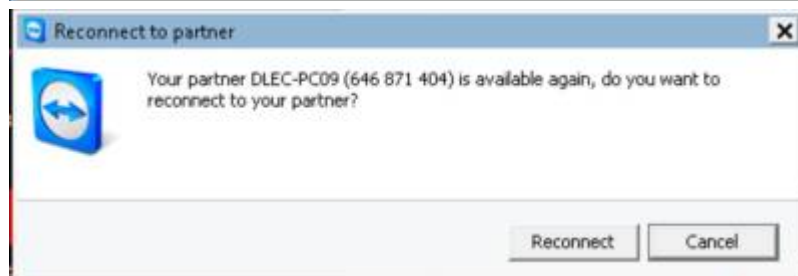

From: <https://wiki.questwork.com/dokuwiki/> - Questwork's Wiki

Permanent link: <https://wiki.questwork.com/dokuwiki/doku.php?id=course:teamviewer:start&rev=1618292827>

Last update: 2021/04/13 13:47



